

NEW



Test-it™

HIV 1/2 Single Test

Detects HIV 1 and HIV 2
Antibodies in Blood,
Serum and Plasma

Warnings:

Read instructions before use. Do not use if expired. Open foil pouch at the time of intended use. Not for internal use. Single use only. Store between 2°C to 30°C (do not freeze).



Manufactured for
LIFESADX, INC.
www.lifesadx.com

! Use new cassette, pipette and lancet for each patient.

NB: All positive results must be confirmed with further laboratory tests.

1 Read instructions before use.

2 Check expiry date on the foil pouch.
Do not use if expired.

3 Clean the finger puncture site with the alcohol swab, allow to dry.



4 Twist to remove protective cap from the safety lancet.

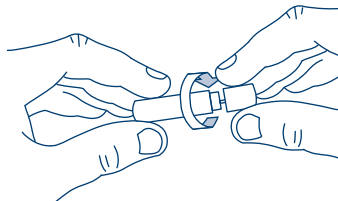

5 Push the open end of the lancet firmly against the finger to activate.

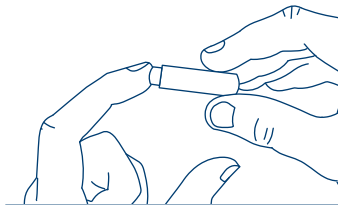

6 Fill plastic pipette supplied to the first line indicated (5ul)

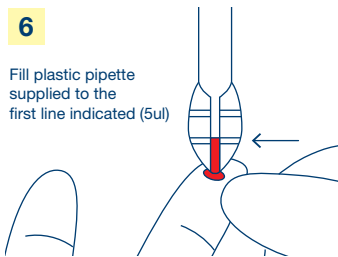

NEW



Test-it™

HIV 1/2 Single Test

Detects HIV 1 and HIV 2 Antibodies in Blood, Serum and Plasma

Warnings:

Read instructions before use. Do not use if expired. Open foil pouch at the time of intended use. Not for internal use. Single use only. Store between 2°C to 30°C (do not freeze).



Manufactured for
LIFESADX, INC.
www.lifesadx.com

7 Add the **collected blood** to the "S" well.

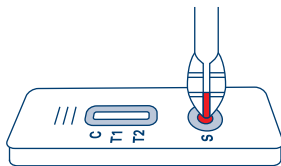

8 Open the buffer.



Carefully twist top section whilst holding bottom section.

9 Add **TWO (2)** drops of buffer to the "S" well.

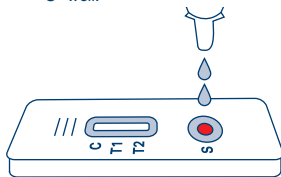

10 Read results **AT 15 minutes**. Reading results too early or too late can give false results.



11 Results:

Negative -

A C-line forms but there is no T1 or T2-line.



Positive -

The T1 or T2 forms together with a C-line.

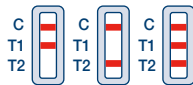

Invalid -

When the C-line does not form, the test must be repeated with a new device.



Contact supplier for technical details.



Hand illustrations by Ddraw / Freepik